

**TITLE : PROPOSED G+5 STORIED RESIDENTIAL CUM COMMERCIAL BUILDING AT PANCHANAN ROAD, NEAR DHAKESHWARI KALI MANDIR DIST.- JALPAIGURI**

**OWNER :**

1. SRI DINESH PODDAR  
S/O LATE SUGRIWMALL PODDAR  
NEELKAMAL APARTMENT, BLOCK-C,  
PRANAMIMANDIR ROAD.  
P.O.- SILIGURI, PIN CODE- 734001,  
DIST.- JALPAIGURI.  
2. SRI PRAMOD KUMAR SINHAL  
S/O LATE RAM KUMAR SINHAL  
MAANSAROVAR HOUSING CO-OPERATIVE SOCIETY LTD.  
PRANAMIMANDIR ROAD.  
P.O.- SILIGURI, PIN CODE- 734001,  
DIST.- JALPAIGURI.

**LAND SCHEDULE**

KHATIAN NO.....	655(R.S.), 870 & 871(L.R.)	PARGANA.....	BAIKUNTHAPUR
J.L. NO.....	02	PLOT NO.....	396/837(R.S.), 258(L.R.)
MOUZA.....	DABGRAM	SHEET NO.....	11 (R.S.), 110 (L.R.)
P.S.....	BHAKTINAGAR	DIST.....	JALPAIGURI

**AREA CALCULATION :**

Triangle Mkd.	Side(a)	Side(b)	Side(c)	S=1/2(a+b+c)	$\Delta=\{s(s-a)(s-b)(s-c)\}$	AREA IN Sq.M
1	11.470	3.425	11.820	13.3575	385.0223	19.622
2	11.820	12.280	23.840	23.9700	442.5906	21.038
3	23.840	14.180	28.925	33.4725	28287.0973	168.188
4	28.925	28.265	25.985	41.5875	109461.7009	330.850
5	25.985	14.200	23.290	31.7375	27047.3814	164.461
6	23.290	18.370	27.845	34.7525	45078.1901	212.316
7	27.845	3.945	25.205	28.4975	1503.1724	38.771
8	25.205	3.505	23.100	25.9050	1139.3641	33.754
9	23.100	15.635	19.340	29.0375	22408.2762	149.694
<b>TOTAL AREA</b>						<b>1138.694 SQM.</b>

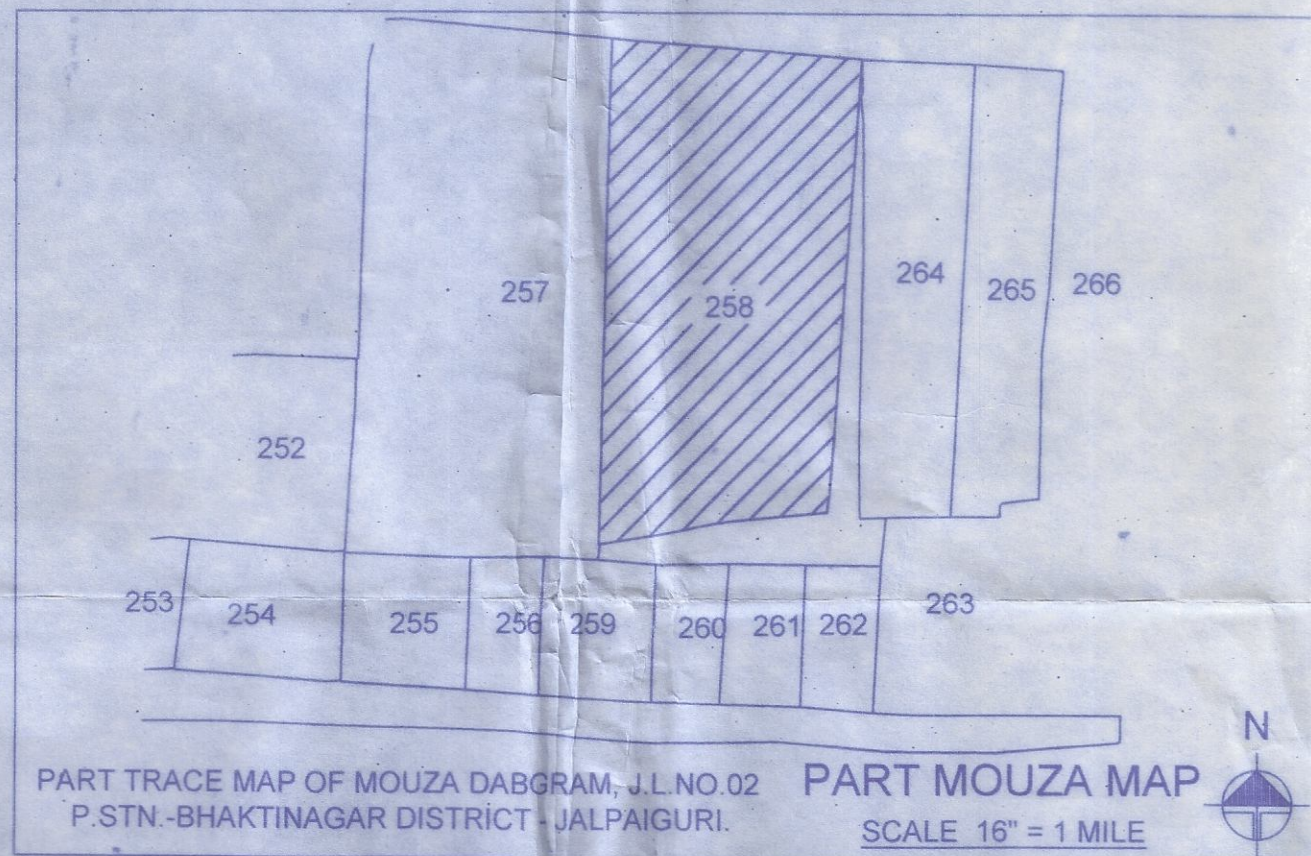
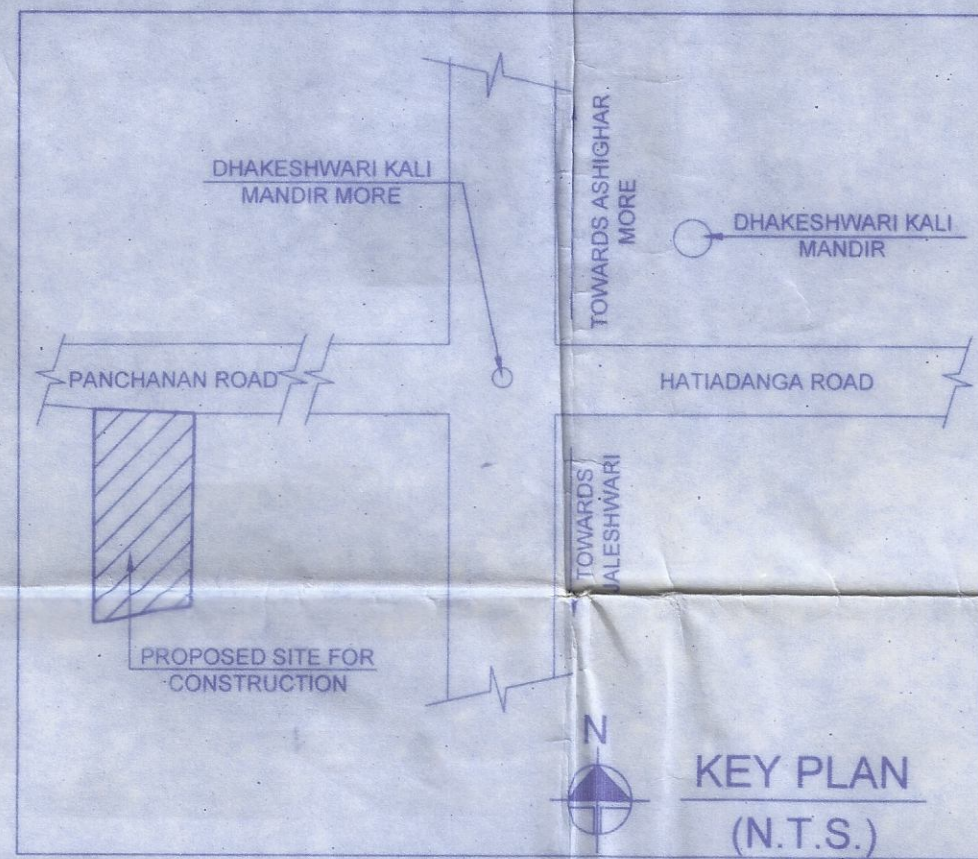

AREA OF LAND(As per DEED) = 1140.14 sqm.  
AREA OF LAND(As per KHATIAN) = 1138.776 sqm.  
AREA OF LAND(As per measurment) = 1138.694 sqm.

COMMERCIAL USE : 91.1 sqm. (8% OF THE LAND AREA)  
RESIDENTIAL USE : 1047.594 sqm. (92% OF THE LAND AREA)



Memo No. 0909 RAJPSIP-  
Date 06/12/2021

APPROVED  
Executive Officer  
Rajganj Panchayat Samity,  
P.O.Rajganj, Dist. Jalpaiguri

*Rahul Majumdar*  
Junier Engineer (A-I)  
Rajganj Panchayet Samity

SIGNATURE OF OWNER

1. *Dinesh Poddar*  
2. *Pramod Kumar Sinhal*

SIGNATURE OF L.B.S.

*Rahul Majumdar*  
RAHUL MAJUMDAR  
CA/2009/46912

LAND OF RAJEN KHARATI

LAND OF NARAYAN MANDAL

10.175 M WIDE ROAD